



**Table 2 - Cable Entry Data**

ENTRY ORDER NUMBER	Y ±.015 DIA.	Z ±.010 DIA.
04	.344	.250
06	.469	.375
08	.594	.500
10	.719	.625
12	.844	.750
14	.969	.875
16	1.094	1.000
18	1.219	1.125
20	1.344	1.250
22	1.469	1.375
24	1.594	1.500

**Table 3 - Length Code Data**

CONN CODE NUMBER	L MAX
40	1.250
41	1.250
54	1.250

**OTHER CONNECTOR CODES AVAILABLE**  
**CONTACT ENGINEERING FOR DETAILS**

WHEN MAXIMUM CABLE ENTRY EXCEEDS THE CONNECTOR INTERFACE DIAMETER, A 2 PIECE ADAPTER WILL BE SUPPLIED.

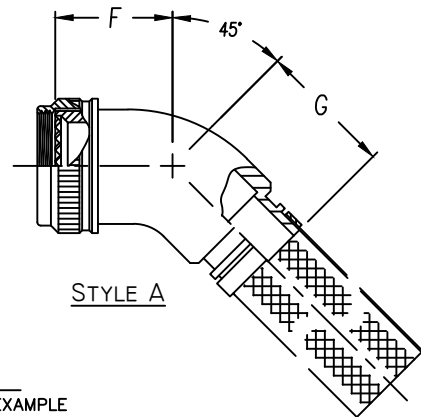
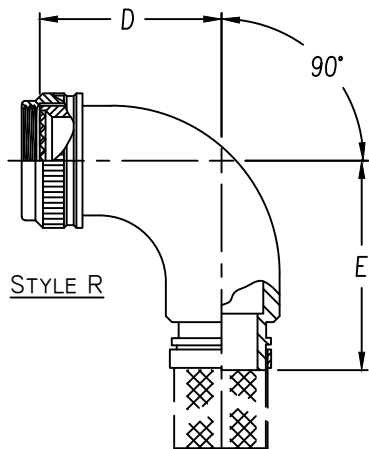
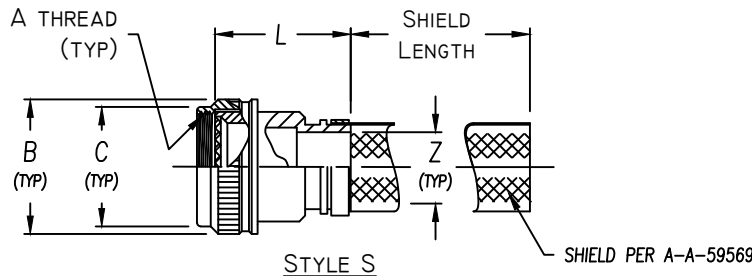

**ASSEMBLY PART NUMBER**  
 TO ESTABLISH YOUR P/N, USE THE FOLLOWING EXAMPLE

**E 4 1 1 1 S 2 3 0 8 2 0 6 B 5 1**

FUNCTION DESIGNATOR  
 A-NON EMI ADAPTER

CONNECTOR CODE NUMBER - TABLE 1 (6)

SERIES PART NUMBER

ADAPTER STYLE  
 S = STRAIGHT SPIN COUPLING ADAPTER  
 R = 90° ADAPTER  
 A = 45° ADAPTER

ACCESSORY ORDER NUMBER-TABLE 1

CABLE ENTRY DATA - TABLE 2

MOD CODE (6)

PLATING CODE NUMBER-TABLE 4 (6)

GLAND & O'RING MATERIAL OPTION  
 B - NEOPRENE & BUNA-N  
 S - SILICONE  
 N - NONE REQUIRED (NON ENVIROMENTAL)

SHIELD LENGTH CODE  
 SHIELD LENGTHS CHOSEN IN 1.00 INCH INCREMENTS  
 (I.E. 08 = 8.00"). MIN LENGTH IS 3.00" CODE 03,  
 MAX LENGTH IS 200" CODE 200(00 FOR NO SHIELD)

SHIELD OPTION  
 1 - SINGLE LAYER TINNED COPPER  
 2 - DOUBLE LAYER TINNED COPPER  
 0 - NO SHIELDING OR DRIVE BAND REQUIRED.

# Table 1 - Order Number Data

E \* \* 11

SHEET 2 OF 2

## Accessory Order Number By Connector Code & Shell Size

ORDER NUMBER	MIL-DTL-38999 SERIES III & IV		MIL-DTL-38999 SERIES I & II		MIL-DTL-3015 CRIMP		MIL-DTL-20482 SER 2		MIL-DTL-83723 SER III		MIL-C-81703 NAS 1509		ORDER NUMBER
	40	41	54		A UNIFIED THREAD	B MAX DIA.	C MAX DIA.	D REF DIM.	E REF DIM.	F REF DIM.	G REF DIM.		
01					.375-32	.750	.531						01
03					.438-27	.812	.594						03
04		8, 9			.438-28	.812	.594	1.125	1.375	.812	1.062		04
05			8 & 8S		.500-20	.875	.656						05
06					.500-28	.875	.656						06
07	9, A				M12 x 1.0	.719	.656						07
08		10, 11		3	.562-24	.844	.719						08
10			10, 10S, 10SL		.625-24	1.000	.781	1.250	1.500	.875	1.125		10
11					.625-28	1.000	.781						11
12	11, B				M15 x 1.0	.844	.781						12
13		12, 13			.688-24	1.062	.844						13
15			12 & 12S	7	.750-20	1.125	.906	1.375	1.625	.938	1.188		15
16	13, C				M18 x 1.0	.969	.906						16
18		14, 15			.812-20	1.188	.969						18
19			14 & 14S	12	.875-20	1.250	1.031	1.500	1.750	1.000	1.250		19
20					.875-28	1.250	1.031						20
21	15, D				M22 x 1.0	1.094	1.031						21
23		16, 17			.938-20	1.312	1.094						23
24			16 & 16S	19	1.000-20	1.375	1.156	1.625	1.875	1.062	1.312		24
25					1.000-28	1.375	1.156						25
26	17, E				M25 x 1.0	1.219	1.156						26
28		18, 19	18	27	1.062-18	1.438	1.219						28
29					1.125-18	1.500	1.281						29
30					1.125-24	1.500	1.281	1.750	2.000	1.094	1.375		30
31					1.125-28	1.500	1.281						31
32	19, F				M28 x 1.0	1.344	1.281						32
34		20, 21	20	37	1.188-18	1.562	1.344						34
35					1.250-18	1.625	1.406	1.875	2.125	1.156	1.406		35
36					1.250-28	1.625	1.406						36
37	21, G				M31 x 1.0	1.469	1.406						37
39		22, 23	22		1.312-18	1.688	1.469						39
40					1.375-18	1.750	1.531	2.000	2.250	1.188	1.438		40
41					1.375-28	1.750	1.531						41
42	23, H				M34 x 1.0	1.594	1.531						42
44		24, 25	24		1.438-18	1.812	1.594						44
45				61	1.500-18	1.875	1.656						45
46					1.500-28	1.875	1.656	2.125	2.375	1.250	1.500		46
47	25, J				M37 x 1.0	1.719	1.656						47
48					1.562-18	1.938	1.719						48
49					1.625-18	2.000	1.781	2.375	2.625	1.344	1.625		49
51			28		1.750-18	2.125	1.906						51
52					1.875-16	2.250	2.031						52
53					1.906-18	2.281	2.062	2.625	2.875	1.438	1.688		53
54			32		2.000-18	2.375	2.156						54
55					2.062-16	2.469	2.219						55
56					2.062-24	2.469	2.219						56
57					2.125-16	2.500	2.281	2.875	3.125	1.562	1.812		57
58					2.125-18	2.500	2.281						58
59			36		2.250-16	2.625	2.406						59
60					2.312-16	2.719	2.469						60
61					2.375-16	2.750	2.531	3.125	3.375	1.688	1.938		61
62			40		2.500-16	2.875	2.656						62

NOTES: UNLESS OTHERWISE SPECIFIED.

- 1 THREADS ARE RIGHT HAND IN ACCORDANCE WITH FED-STD-H28, CLASS 2B.
- ③ THREADS NOTED ARE ISO METRIC, CLASS 6H.
- 5 TABLE 1 LISTS THE MOST USED CONNECTOR CODES. SEE SECTION 11 FOR OTHER CODES AVAILABLE AND COMPLETE CONNECTOR PART NUMBER CROSS REFERENCE.
- ⑥ SEE SUPPORT DATA SECTION FOR PLATING AND MODIFICATION CODE OPTIONS.
- ⑧ SEE SUPPORT DATA SECTION FOR TABLE V & AVAILABLE STYLES