

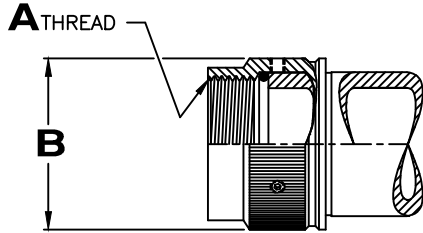

**Connector Code 18
 MIL-DTL-5015
 SOLDER**



Style A, R & S

MIL-DTL-5015, SOLDER CONTACTS
 CLASS A, E, F & R. MS3100,
 MS3101, MS3106 & MS3107
 (REPLACES ENDBELL & GROMMET)
 AMPHENOL PRODUCTS
 AMPHENOL 69 & 97 SERIES
 BENDIX 10-214, 10-72* SERIES
 ITT CANNON CA-E, CA-R &
 CA-RX SERIES

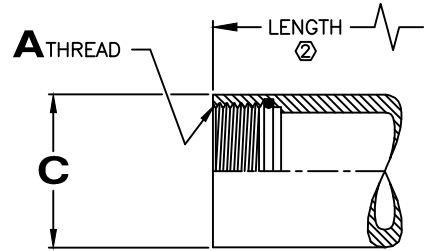

Style B

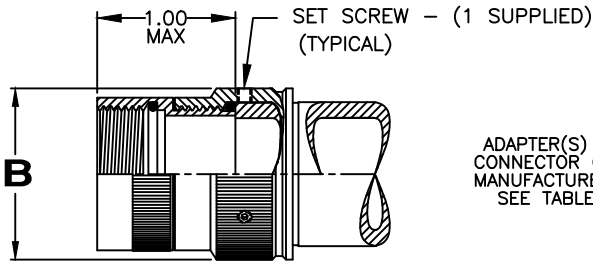

ADAPTER(S) SUPPLIED FOR
 CONNECTOR CODE "D" WHEN
 MANUFACTURER IS UNKNOWN
 SEE TABLE 1, NOTE ④

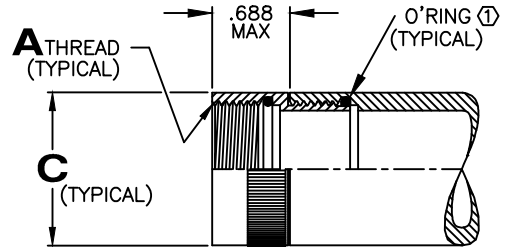

**Connector Code 19
 MIL-DTL-83723, SERIES II**

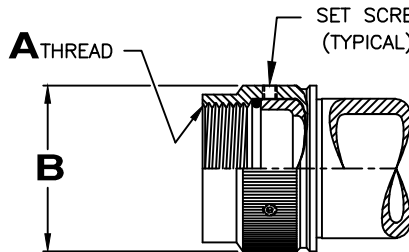

Style A, R & S

MIL-DTL-83723, SERIES II
 CLASS A, G & R
 M83723/17, /18, /19, /20,
 /23, /24, /52 & /53
 ITT CANNON CV* SERIES
 MATRIX M730* SERIES
 AERO ELECTRIC AE723 SERIES

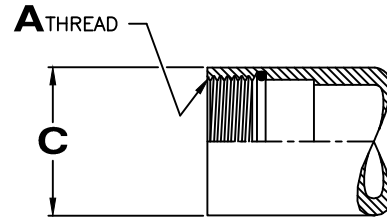

Style B

**Connector Code 21
 MIL-DTL-26482, SERIES 1**

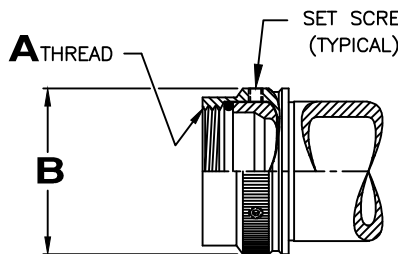

Style A, R & S

MIL-DTL-26482, SERIES 1
 CLASS A, E, F & P
 MS3110, MS3111, MS3116
 MS3120, MS3121, MS3126 & MS3128
 (REPLACES ENDBELL & GROMMET RING)
 AMPHENOL PRODUCTS
 BENDIX PT** & PT**SE SERIES
 BURNDY BT & L**T SERIES
 ITT CANNON LPT & KPTM SERIES
 DEUTSCH ECD BTK & LPT SERIES
 GENERAL CONNECTOR GC SERIES

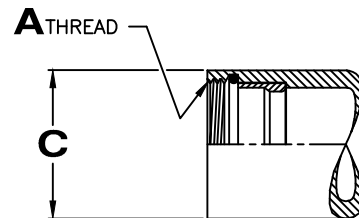

Style B



**Connector Code 30
 MIL-DTL-28840**

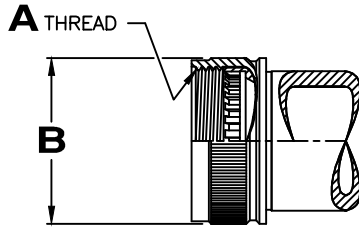

Style A, R & S

INTERFACE PER MIL-DTL-28840
 FIGURE 7
 O'RING NOT REQUIRED / SUPPLIED

MIL-DTL-28840,
 CLASS A, B, C & E
 M28840/10, /11, /14 & /16
 ITT CANNON KFS SERIES
 HUGHES C. D. GTA SERIES
 S.A.E. HD SERIES

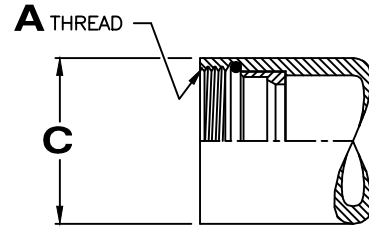

Style B

**Connector Code 32
 MIL-DTL-22992**

Left Hand

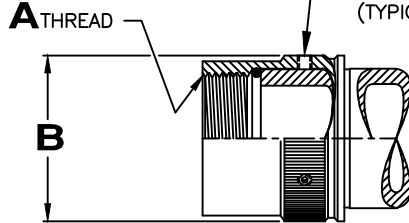

Style A, R & S

MIL-DTL-22992,
 CLASS C, J & R
 MS17343, MS17344,
 MS17345 & MS17346
 AMPHENOL PRODUCTS
 BENDIX QWLD SERIES
 ITT CANNON CWLD SERIES

Left Hand

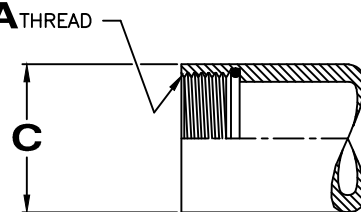

Style B

**Connector Code 40
 MIL-DTL-38999**

Metric

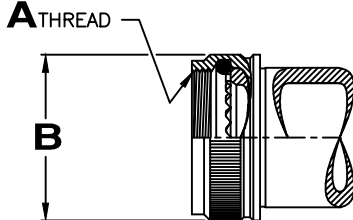

Style A, R & S

INTERFACE PER SAE AS85049
 FIGURE 3

MIL-DTL-38999, SERIES III & IV
 CLASS C, F, K & W
 D38999/20, /24, /26,
 /40, /44, /46 & /47
 AMPHENOL PRODUCTS
 BENDIX TVP SERIES
 ITT CANNON KJA SERIES
 G & H TECHNOLOGY BL SERIES
 PYLE NATIONAL T3 SERIES
 FLIGHT PL SERIES
 DEUTCH DIV SERIES
 TRW CINCH CN SERIES
 AERO-ELECTRIC AE22 SERIES

EN3645

Metric

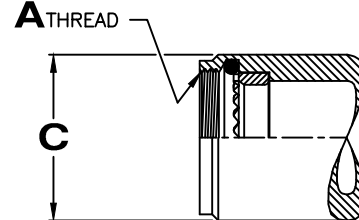

Style B



**Connector Code 41
 MIL-DTL-38999**

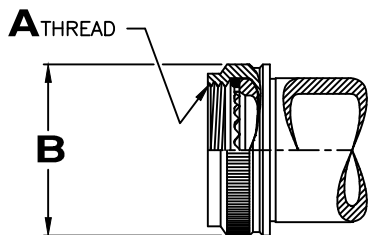

Style A, R & S
 INTERFACE PER SAE AS85049
 FIGURE 2

MIL-DTL-38999, SERIES I & II
 CLASS E, P & T
 MS27466, MS27467, MS27468,
 MS27472, MS27473, MS27474,
 MS27479, MS27480, MS27481,
 MS27484, MS27497, MS27652,
 MS27653 & MS27656
 40M38277

AMPHENOL PRODUCTS
 AMPHENOL 418-1 & 418-2 SERIES
 BENDIX LJ** & JT** SERIES
 ITT CANNON KJL & KJ SERIES
 AERO-ELECTRIC AE4* SERIES

PAN 6433-1
 PATT 614
 PATT 616
 NFC 93422 HE308
 NFC 93422 HE309

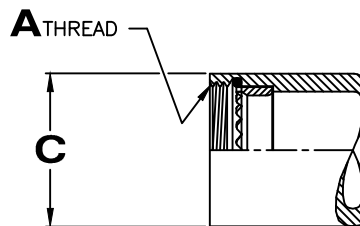

Style B

Connector Code 47

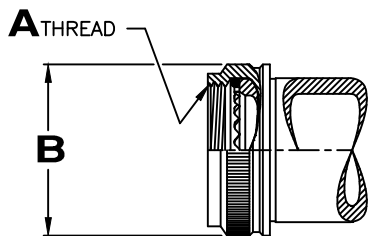

Style A, R & S

AMPHENOL PRODUCTS
 BENDIX SJT SERIES

LN 29729
 PATT 615
 PAN 6433-2
 EN3372
 NFC93422 HE306
 VG 96912

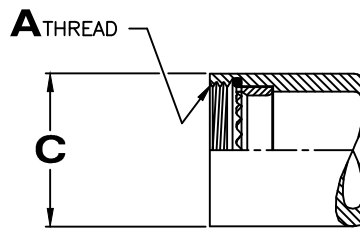

Style B

**Connector Code 51
 MIL-DTL-26500**

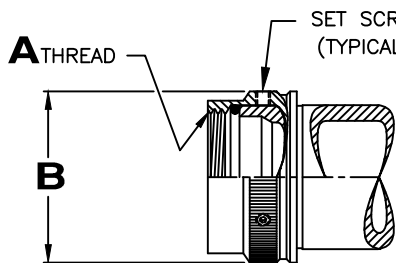

Style A, R & S

MIL-DTL-26500, (ALUMINUM SHELL)
 CLASS F, G & R.
 MS24264, MS24265 & MS24266

AMPHENOL PRODUCTS
 AMPHENOL 48 SERIES
 TRW CINCH 48 SERIES
 PYLE NATIONAL ZZB SERIES

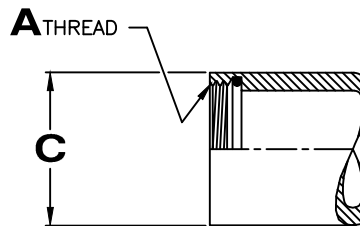

Style B



**Connector Code 54
 MIL-DTL-5015 CRIMP, etc.**

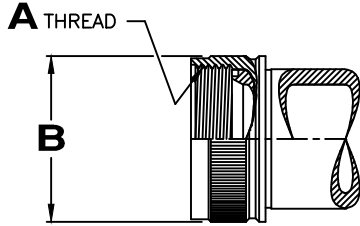

Style A, R & S
 INTERFACE PER SAE AS85049
 FIGURE 4
 O'RING NOT REQUIRED / SUPPLIED

MIL-DTL-5015, CRIMP CONTACTS
 CLASS D, L, U & W
 MS3400, MS3401, MS3404, MS3406,
 MS3450, MS3451, MS3454, MS3456 & MS3459
MIL-DTL-26482, SERIES 2, CLASS A & L
 MS3470, MS3471, MS3472, MS3474, & MS3476
MIL-C-81703, SERIES 3, CLASS E & L
 MS3424, MS3446, MS3464, MS3467 & MS3468
MIL-DTL-83723, SERIES I & III
 CLASS A, G, K, R & S
 M83723/1, /2, /3, /4, /5, /6, /7, /8,
 /13, /14, /36, /37, /38, /39, /40, /41, /42,
 /43, /48, /49, /65, /66, /67, /68, /69, /71,
 /72, /73, /74, /75, /76, /77, /78, /82, /83,
 /84, /85, /86, /87, /91, /95, /97 & /98
 40M39569

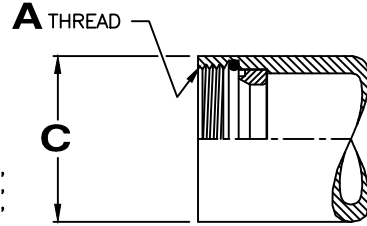

Style B

AMPHENOL PRODUCTS
 AMPHENOL 518 SERIES
 BENDIX PTS-DR SERIES
 ITT CANNON
 CV340, CV345 & PV7 SERIES
 DEUTSCH AFD5, DBA3, DBA5,
 DL6 & 837 SERIES
 MATRIX 944, MB3 & MT3 SERIES
 PYLE NATIONAL BG, BJ, BJK,
 EB & ET SERIES
 DEF 5326-3
 EN 2997, EN 3646
 LN 29504
 NFC 93422 HE302
 PAN 6432-1, PAN 6432-2
 PATT 602

**Connector Code 61
 MIL-DTL-81511**

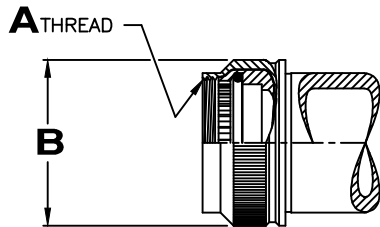

Style A, R & S
 INTERFACE PER MIL-DTL-81511
 FIGURE 12C

MIL-DTL-81511, SERIES 1, 2, 3 & 4
 CLASS A, C, E, F, P & T
 M81511/1, /3, /5, /6, /21, /23, /25,
 /26, /31, /32, /33, /34, /35, /36,
 /37, /38, /41, /45, /46, /49,
 /51, /53, /55 & /56

AMPHENOL PRODUCTS
 AMPHENOL 348 SERIES
 DEUTSCH ECD
 A815 & B815 SERIES

VG 95329

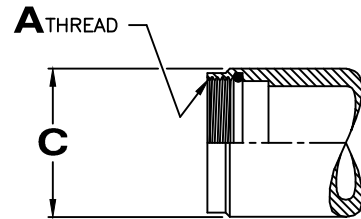

Style B

Connector Code 76

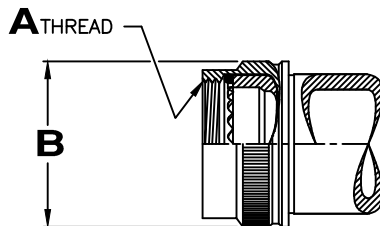

Style A, R & S

PATT 105
 PATT 603
 PATT 608

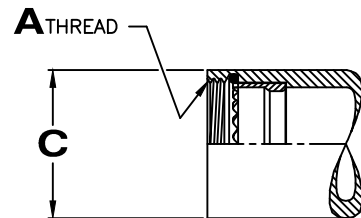

Style B

GENERAL NOTES:

1 CONSULT FACTORY FOR INFORMATION ON CONNECTOR CODES NOT SHOWN