



ELECTRO ADAPTER INC.
CHATSWORTH, CALIFORNIA, USA 91311
PHONE : (818) 998-1198
FAX : (818) 709-5773

**SECTION 1 - MECHANICAL
STRAIN RELIEF, ENVIRONMENTAL ,
GLAND SEAL
SAE AS85049 CATEGORY 2B**

A * * 01

SHEET 1 OF 2

Add'l ENG Support Information

Table 2 - Cable Entry Data

ENTRY ORDER NUMBER	ENVIRONMENTAL GLAND RANGE		NON ENVIRONMENTAL CABLE RANGE		V UNIFIED THREAD
	MAX	MIN	MAX	MIN	
03	.250	.156	.250	.156	.500-28
04	.312	.188	.312	.188	.625-24
06	.438	.281	.438	.281	.750-20
08	.562	.375	.562	.344	.875-20
10	.625	.500	.625	.375	1.000-20
12	.750	.500	.750	.438	1.188-18
16	.938	.625	.938	.562	1.438-18
20	1.250	.938	1.250	.750	1.750-18
24	1.375	1.000	1.375	.781	2.000-18
28	1.625	1.250	1.625	.969	2.250-16
32	1.875	1.500	1.875	1.125	2.500-16

WHEN MAXIMUM CABLE ENTRY EXCEEDS THE
CONNECTOR INTERFACE DIAMETER, A 2 PIECE
ADAPTER WILL BE SUPPLIED.

Table 3 - Length Code Data

CONN CODE NUMBER	MIN ORDER LENGTH	MIN LENGTH CODE
40	1.250	05
41	1.250	05
54	1.250	05

**OTHER CONNECTOR CODES AVAILABLE
CONTACT ENGINEERING FOR DETAILS**

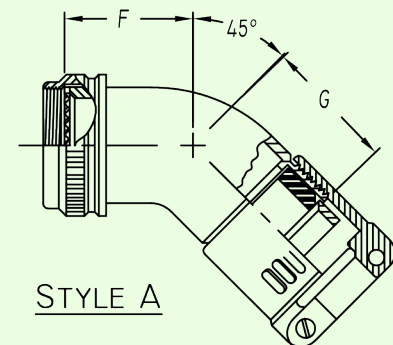
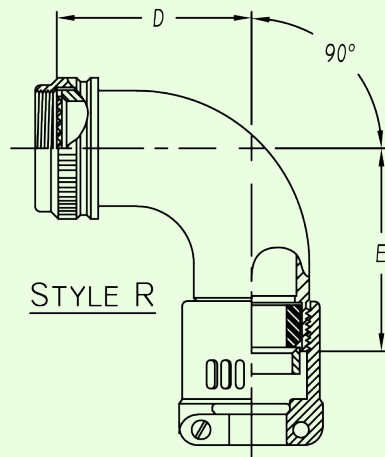
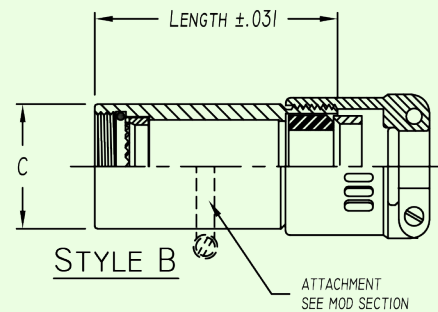
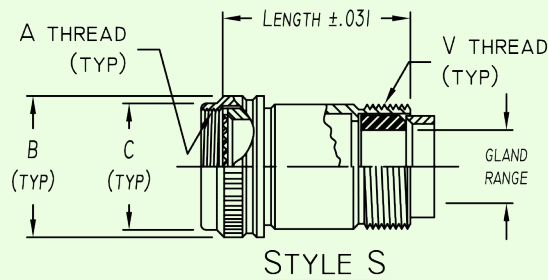

ASSEMBLY PART NUMBER

TO ESTABLISH YOU P/N, USE THE FOLLOWING EXAMPLE

A 41 01 S 23 08 9 B 06 51

FUNCTION DESIGNATOR
A-NON EMI ADAPTER

CONNECTOR CODE NUMBER - TABLE 1 (6)

SERIES PART NUMBER

ADAPTER STYLE
S = STRAIGHT SPIN COUPLING ADAPTER
B = STRAIGHT BASIC ADAPTER
R = 90° ADAPTER
A = 45° ADAPTER

ACCESSORY ORDER NUMBER-TABLE 1

MOD CODE (6)

PLATING CODE NUMBER-TABLE 4 (6)

LENGTH CODE NUMBER
LENGTHS ARE CHOSEN IN 1/4" INCREMENTS
(IE 08=2.00") SEE TABLE 3 FOR MINIMUM
INSERT 00 FOR R & A STYLE ADAPTERS

GLAND & O'RING MATERIAL OPTION
B - NEOPRENE & BUNA-N
S - SILICONE
N - NONE REQUIRED (NON ENVIROMENTAL)

CABLE STRAIN-TABLE V (8)

CABLE ENTRY ORDER NUMBER-TABLE 2

REV B

Table 1 - Order Number Data

A * * 01
SHEET 2 OF 2

Accessory Order Number By Connector Code & Shell Size

ORDER NUMBER	<div>MIL-DTL-38999 SERIES III & IV</div> <div>MIL-DTL-38999 SERIES I & II</div> <div>MIL-DTL-5015 CRIMP MIL-DTL-28442 SER 2 MIL-DTL-83723 SER III</div> <div>MIL-C-81703 NAS 1599</div>				A	B	C	D	E	F	G	ORDER NUMBER
	40 ③	41	54		UNIFIED THREAD	MAX DIA.	MAX DIA.	REF DIM.	REF DIM.	REF DIM.	REF DIM.	
01					.375-32	.750	.531					01
03					.438-27	.812	.594					03
04		8, 9			.438-28	.812	.594	1.125	1.188	.812	.875	04
05			8 & 8S		.500-20	.875	.656					05
06					.500-28	.875	.656					06
07	9, A				M12 x 1.0	.719	.656					07
08		10, 11		3	.562-24	.844	.719					08
10			10,10S,10SL		.625-24	1.000	.781	1.250	1.312	.875	.938	10
11					.625-28	1.000	.781					11
12	11, B				M15 x 1.0	.844	.781					12
13		12, 13			.688-24	1.062	.844					13
15			12 & 12S	7	.750-20	1.125	.906	1.375	1.438	.938	1.000	15
16	13, C				M18 x 1.0	.969	.906					16
18		14, 15			.812-20	1.188	.969					18
19			14 & 14S	12	.875-20	1.250	1.031	1.500	1.562	1.000	1.062	19
20					.875-28	1.250	1.031					20
21	15, D				M22 x 1.0	1.094	1.031					21
23		16, 17			.938-20	1.312	1.094					23
24			16 & 16S	19	1.000-20	1.375	1.156	1.625	1.688	1.062	1.125	24
25					1.000-28	1.375	1.156					25
26	17, E				M25 x 1.0	1.219	1.156					26
28		18, 19	18	27	1.062-18	1.438	1.219					28
29					1.125-18	1.500	1.281	1.750	1.812	1.094	1.156	29
30					1.125-24	1.500	1.281					30
31					1.125-28	1.500	1.281					31
32	19, F				M28 x 1.0	1.344	1.281					32
34		20, 21	20	37	1.188-18	1.562	1.344	1.875	1.938	1.156	1.219	34
35					1.250-18	1.625	1.406					35
36					1.250-28	1.625	1.406					36
37	21, G				M31 x 1.0	1.469	1.406					37
39		22, 23	22		1.312-18	1.688	1.469	2.000	2.062	1.188	1.250	39
40					1.375-18	1.750	1.531					40
41					1.375-28	1.750	1.531					41
42	23, H				M34 x 1.0	1.594	1.531					42
44		24, 25	24		1.438-18	1.812	1.594					44
45				61	1.500-18	1.875	1.656	2.125	2.188	1.250	1.312	45
46					1.500-28	1.875	1.656					46
47	25, J				M37 x 1.0	1.719	1.656					47
48					1.562-18	1.938	1.719					48
49					1.625-18	2.000	1.781	2.375	2.625	1.344	1.625	49
51			28		1.750-18	2.125	1.906					51
52					1.875-16	2.250	2.031					52
53					1.906-18	2.281	2.062	2.625	3.000	1.438	1.812	53
54			32		2.000-18	2.375	2.156					54
55					2.062-16	2.469	2.219					55
56					2.062-24	2.469	2.219					56
57					2.125-16	2.500	2.281	2.875	3.250	1.562	1.938	57
58					2.125-18	2.500	2.281					58
59			36		2.250-16	2.625	2.406					59
60					2.312-16	2.719	2.469					60
61					2.375-16	2.750	2.531	3.125	3.500	1.688	2.062	61
62			40		2.500-16	2.875	2.656					62

NOTES: UNLESS OTHERWISE SPECIFIED.

1 THREADS ARE RIGHT HAND IN ACCORDANCE
WITH FED-STD-H28, CLASS 2B.

③ THREADS NOTED ARE ISO METRIC, CLASS 6H.

⑥ SEE SUPPORT DATA SECTION FOR PLATING
AND MODIFICATION CODE OPTIONS.⑧ SEE SUPPORT DATA SECTION FOR TABLE V &
AVAILABLE STYLES

REV B