



ELECTRO ADAPTER INC.
 CHATSWORTH, CALIFORNIA, USA 91311
 PHONE (818) 998-1198
 FAX (818) 709-5773

**SECTION 2 - BANDING TERMINATION
 IBISS, 90° SPLIT SHELL, DUAL BAND,
 MIL-DTL-5015, MIL-DTL-26482 SERIES 2,
 & MIL-DTL-83723 SERIES III**

901-716

SHEET 1 OF 1

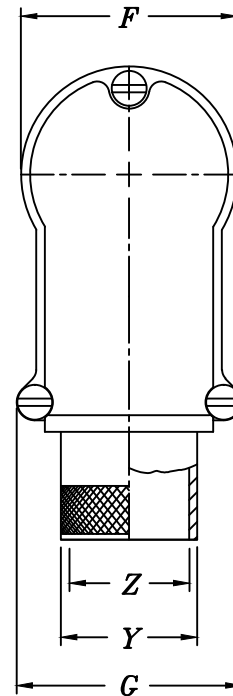
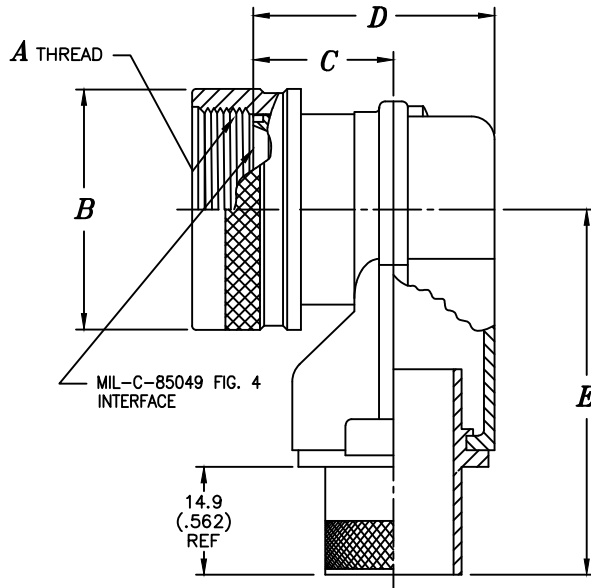

EXAMPLE PART NUMBER

901-716160655

BASIC PART NUMBER

PLATING CODE NUMBER

CODE 55 - CADMIUM PER SAE-AMS-QQ-P-416, TYPE II,
 CLASS 3, OVER ELECTROLESS NICKEL PER
 AMS-C-26074, CLASS 3 OR 4, GRADE B
 (1000 HR. SALT SPRAY)

FOR ADDITIONAL FINISH OPTIONS, SEE TABLE 4

CONNECTOR INTERFACE DATA

CONN. ORDER NO.	SHELL SIZE Δ 3	A UNIFIED THREAD CLASS 2B	B MAX	C REF.	D MAX.	E MAX.	F ±.094	G ±.094	MAX. ENTRY SIZE
0 8	8	.500-20	18.3 (.719)	15.0 (.590)	23.8 (.938)	35.0 (1.375)	21.4 (.844)	22.6 (.890)	0 4
1 0	10	.625-24	19.8 (.781)	15.0 (.590)	27.2 (1.070)	47.0 (1.850)	25.0 (.984)	26.2 (1.030)	0 5
1 2	12	.750-20	23.0 (.906)	15.0 (.590)	27.2 (1.070)	47.0 (1.850)	25.0 (.984)	26.2 (1.030)	0 5
1 4	14	.875-20	26.2 (1.031)	15.0 (.590)	27.2 (1.070)	47.0 (1.850)	25.0 (.984)	26.2 (1.030)	0 6
1 6	16	1.000-20	29.4 (1.156)	15.9 (.625)	29.7 (1.170)	49.6 (1.950)	28.6 (1.125)	29.7 (1.171)	0 6
1 8	18	1.062-18	31.4 (1.238)	20.9 (.823)	34.9 (1.375)	52.1 (2.050)	34.1 (1.344)	31.3 (1.234)	0 6
2 0	20	1.188-18	35.0 (1.375)	20.7 (.813)	34.7 (1.365)	52.1 (2.050)	34.1 (1.344)	31.3 (1.234)	0 8
2 2	22	1.312-18	37.6 (1.481)	20.7 (.813)	36.8 (1.450)	52.1 (2.050)	37.3 (1.469)	35.3 (1.390)	0 8
2 4	24	1.438-18	41.0 (1.613)	20.5 (.806)	36.7 (1.443)	52.1 (2.050)	37.3 (1.469)	35.3 (1.390)	1 0

ENTRY DATA

ENTRY ORDER NO.	Z REF. DIA.	Y REF. DIA.
0 3	4.0/ (.157)	5.0/ (.196)
0 4	5.5/ (.216)	6.5/ (.255)
0 5	7.5/ (.295)	8.5/ (.334)
0 6	9.5/ (.375)	10.5/ (.413)
0 7	10.5/ (.413)	11.5/ (.452)
0 8	12.5/ (.492)	13.5/ (.531)
0 9	14.0/ (.551)	15.0/ (.590)
1 0	15.5/ (.610)	16.5/ (.649)

NOTES: UNLESS OTHERWISE SPECIFIED

1. ASSEMBLY IDENT. PER MIL-STD-1285.

2. MATERIAL: ADAPTER COMPONENTS - ALUMINUM ALLOY

Δ 3 CONNECTOR/ADAPTER INTERFACE PER SAE AS85049 FIGURE 4.

4. SELF-LOCKING COUPLING.



STANDARD FINISHES

PLATING CODE	FINISH	SPECIFICATION	ACCESSORY MATERIAL	CORROSION RESISTANCE (HRS)	ROHS COMPLIANT
0 3	CADIUM PLATE, OLIVE DRAB	SAE AMS-QQ-P-416, TYPE II, CLASS 3	ALUMINUM	96	NO
1 0	PASSIVATE	SAE AMS-QQ-P-35, (AS85049 CODE S)	STAINLESS STEEL	1000	YES
1 2	ZINC NICKEL, BLACK	ASTM B841	ALUMINUM	500	YES
1 3	ZINC COBALT, OLIVE DRAB	ASTM B840-99	ALUMINUM	96	NO
1 4	ZINC COBALT, BLACK	ASTM B840-99	ALUMINUM	96	NO
2 1	IRIDITE, 14-2, GOLD	IRIDITE, NUMBER 14-2 PER MIL-DTL-5541 CL 3	ALUMINUM	96	NO
3 4	ANODIZE, BLACK	MIL-A-8625, TYPE II, CL 3 (AS85049 CODE A)	ALUMINUM	1000	YES
3 5	ANODIZE ,GREY	MIL-A-8625, TYPE II, CLASS 2	ALUMINUM	500	YES
4 4	ANODIZE, HARD, BLACK	MIL-A-8625, TYPE II, CLASS 2	ALUMINUM	500	YES
4 5	ANODIZE, HARD, GREY	MIL-A-8625, TYPE II, CLASS 2	ALUMINUM	1000	YES
4 8	ELECTROLESS NICKEL	AMS-2404F, CLASS 4, GRADE B	STAINLESS STEEL	48	NO
5 1	ELECTROLESS NICKEL	AMS-2404F, CLASS 4, GRADE B	ALUMINUM	48	NO
5 5	CADIUM PLATE, OLIVE DRAB, OVER ELECTROLESS NICKEL	SAE AMS-QQ-P-416, TYPE II, CLASS 3, OVER ELECTROLESS NICKEL, PER AMS-2404F (AS85049 CODE W)	ALUMINUM	1000	NO
5 6	ELECTROLESS NICKEL	AMS-2404F, CLASS 4, GRADE A	ALUMINUM	96	NO
5 6 R	ELECTROLESS NICKEL	AMS-2404F, CLASS 4, GRADE A	ALUMINUM	48	YES
5 7	ELECTROLESS NICKEL	AMS-2404F, CLASS 4, GRADE A (AS85049 CODE N)	ALUMINUM	96	NO
64	CADIUM PLATE, OLIVE DRAB, OVER ELECTROLESS NICKEL	SAE AMS-QQ-P-416, TYPE II, CLASS 3, OVER ELECTROLESS NICKEL, PER AMS-2404F (SELECTIVE PLATING REF AS85049 CODE P)	ALUMINUM	1000	NO
85	PASSIVATED	SAE AMS-QQ-P-35	316 SST	1000	YES
87	BEAD BLASTED	N/A	NI. ALUM. BRONZE	1000	YES

NOTES: UNLESS OTHERWISE SPECIFIED

- CORROSION RESISTANCE IS SPECIFIED FOR SALT SPRAY IN ACCORDANCE WITH AS85049
- CONSULT FACTORY FOR OTHER FINISHES
- FINISHES ARE APPLICABLE TO THE CONNECTOR ACCESSORIES ONLY AND EXCLUDE FASTENERS AND OTHER HARDWARE
- EMI/RFI ACCESSORIES ARE SUPPLIED WITH CONDUCTIVE FINISHES ONLY
- ANODIZE NOT SUITABLE FOR EMI SHIELDING OR GROUNDING APPLICATIONS
- ALL THE CONDUCTIVE FINISHES USED ON ALUMINUM CAN ALSO BE USED ON BRASS (CONSULT FACTORY)
- CADMIUM/NICKEL INTERFACE SHALL BE COATED WITH POLYSULFIDE SEALANT (REF FIGURE 2 BELOW)

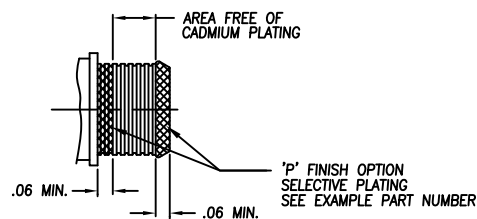

FIGURE 2



STANDARD MATERIALS

COMPONENT	MATERIAL	SPECIFICATION
MACHINED COMPONENTS	ALUMINUM STAINLESS STEEL (300 SERIES) BRASS NICKEL ALUMINUM BRONZE	ASTM B221, ASTM B211 (MFG OPTION) AMS-QQ-S-763, QQ-S-764 (MFG OPTION) QQ-B-626 ASTMB150 (AMS4640)
DIE CAST COMPONENTS	ALUMINUM	ASTM B 85
FASTENERS AND HARDWARE	STAINLESS STEEL (300 SERIES) STEEL BRASS	AMS-QQ-S-763 SAE20, QQ-S-634, QQ-S-637 QQ-B-626
ELASTOMERIC SEALS	SILICONE BUNA-N NEOPRENE	ZZ-R-765B, MIL-R-25988 AMS-3209 MIL-R-3065

NOTES: UNLESS OTHERWISE SPECIFIED

1. THE SPECIFIED MATERIALS ARE STANDARD FOR THE MAJORITY OF CONNECTOR ACCESSORIES
2. CONSULT FACTORY FOR OTHER MATERIALS
3. FOR DOCUMENTS LISTED WITHIN THIS CATALOG WITH OUT A TOLERANCE SHOWN SHALL HAVE TOLERANCES AS FALLOWED:
 - .X = $\pm .2$
 - .XX = $\pm .12$
 - .XXX = $\pm .062$
 - X° = $\pm 10^\circ$