



ELECTRO ADAPTER, INC.
 CHATSWORTH, CALIFORNIA, USA 91311
 PHONE: (818) 998-1198
 FAX: (818) 709-5773
 WEB SITE: www.electro-adapter.com

EMP BAND ADAPTER

AS85049 CATEGORY 3B
 ENTRY SPECIFICATION SHEET *

SPECIFICATION CONTROL DRAWING

217

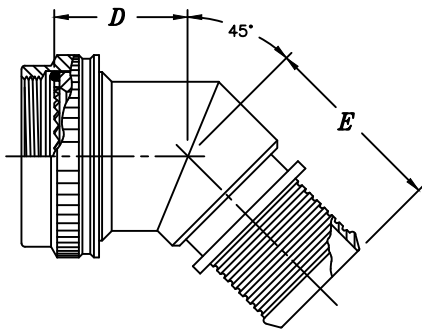

STYLE A

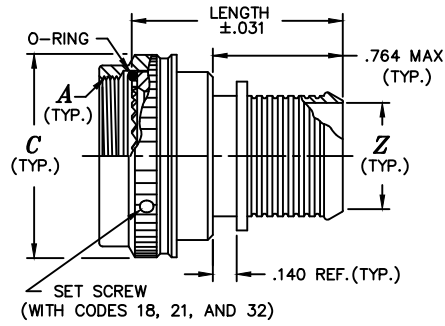

STYLE S

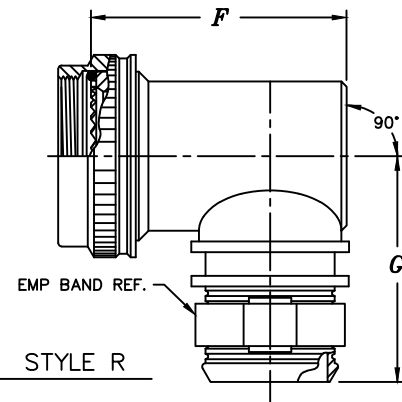

STYLE R

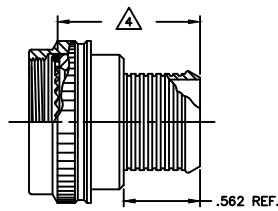

MODIFICATION Z
 (LESS BOOT GROOVE)

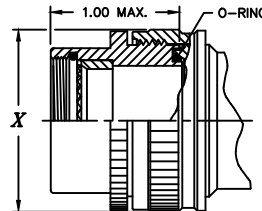

2 PIECE

Example Part Number

21741S161030855S

BASIC ADAPTER NUMBER

STYLE

S = STRAIGHT
 A = 45°
 R = 90°

ORDER NO. PER TABLE II

MODIFICATION CODE

S = SELF LOCKING ROUND COUPLING.
 Z = LESS BOOT GROOVE, OMIT FOR STANDARD BOOT GROOVE

TABLE I - CONNECTOR CODE

MILITARY SPECIFICATION	SERIES	CODE NO.
MIL-DTL-38999	III & IV	4 0
MIL-DTL-38999	I & II	4 1
MIL-DTL-5015G	3400	5 4
MIL-C-81703	3	5 4
MIL-DTL-83723	I	5 4
MIL-DTL-26482	2	5 4
MIL-DTL-83723	III	5 4
NAS1599	-	5 4

TABLE III - ENTRY DATA

ENTRY ORDER NO.	EMP BAND		BOOT P/N REF
	Z +.010 -.020 DIA.	X MAX DIA.	
0 4	.250	N/A	152-42-G-W24
0 6	.375	.734	152-42-G-W24
0 8	.500	.858	154-42-G-W24
1 0	.625	1.112	154-42-G-W24
1 2	.750	1.345	155-42-G-W24
1 4	.875	1.345	156-42-G-W24
1 6	1.000	1.594	156-42-G-W24
1 8	1.125	1.594	157-43-G-W24
2 0	1.250	1.969	157-43-G-W24

PLATING CODE NUMBER

10 = PASSIVATE, PER SAE AMS-QQ-P-35 (MATERIAL=SST)
 12 = ZINC NICKEL, BLACK, PER ASTM B841 OVER ELECTROLESS NICKEL
 12R = ZINC NICKEL, BLACK, PER ASTM B841 OVER ELECTROLESS NICKEL, ROHS COMPLIANT
 55 = CADMIUM, OLIVE DRAB, PER SAE-AMSQQ-P-416, TYPE II, CLASS 3, OVER ELECTROLESS NICKEL
 51 = ELECTROLESS NICKEL PER SAE-AMS-2404F, WITH IRIDITE CONVERSION
 FOR ADDITIONAL FINISH OPTIONS, SEE CATALOG TABLE 4.

LENGTH CODE NUMBER

SELECT LENGTH IN 1/4" INCREMENTS (ie: 08=2.00", 09=2.25", etc.)
 00 FOR 45° & 90° ADAPTERS (STYLES A & R)

MIN. AVAIL. LENGTH	CONNECTOR CODES (TABLE I)
1.250	18, 21, 40, 41
1.500	30, 32, 61



TERMINATION NUMBER

- 1 = ADAPTER ONLY
- 2 = OBSOLETE
- 3 = ADAPTER w/ 214L0002 EMP BAND AND SHRINK SLEEVE
- 4 = ADAPTER w/ 214L0002 EMP BAND
- 5 = ADAPTER w/ 214L0002 EMP BAND AND SHRINK BOOT
- 6 = ADAPTER w/ 214L0006 EMP BAND AND SHRINK BOOT
- 7 = ADAPTER w/ 214L0005 EMP BAND AND SHRINK BOOT
- 8 = ADAPTER w/ 214L0005 EMP BAND
- 9 = ADAPTER w/ 214L0006 EMP BAND



* THIS DOCUMENT INCOMPLETE WITHOUT "INTERFACE SPECIFICATION SHEET".



TABLE II — CONNECTOR CODE 40
 MIL-DTL-38999, SERIES III&IV

ORDER NO.	SHELL SIZE		<i>A</i> METRIC THD. CLASS 6H	ϕC MAX.	<i>D</i> MAX.	<i>E</i> MAX. 	<i>F</i> MAX.	<i>G</i> MAX. 		BAND MAX. 1 PIECE ENTRY	
	COM'L.	MIL.									
0 8	9	A	M12 x 1.0	.703	.52	1.15	.84	1.28		0 4	
1 0	11	B	M15 x 1.0	.827	.54	1.17	.97	1.34		0 6	
1 2	13	C	M18 x 1.0	.953	.57	1.20	1.09	1.41		0 8	
1 4	15	D	M22 x 1.0	1.077	.59	1.23	1.22	1.47		1 0	
1 6	17	E	M25 x 1.0	1.203	.62	1.25	1.34	1.53		1 2	
1 8	19	F	M28 x 1.0	1.327	.63	1.26	1.41	1.59		1 3	
2 0	21	G	M31 x 1.0	1.453	.66	1.29	1.53	1.66		1 5	
2 2	23	H	M34 x 1.0	1.577	.68	1.32	1.66	1.72		1 7	
2 4	25	J	M37 x 1.0	1.703	.71	1.34	1.78	1.78		1 9	

NOTES:

1. ASSEMBLY IDENT. PER MIL-STD-1285.
2. MATERIAL: COMPONENTS — ALUM. ALLOY
 O'RING — SILICONE
-  "2 PIECE" CONFIG. SUPPLIED WHEN CABLE
 ENTRY DIA. EXCEEDS CONN. INSERT DIA..
-  DIMENSIONS INDICATED WILL BE .20" LESS
 WHEN ORDERED WITH MOD. CODE Z.
-  FOR MULTIPLE MOD. CODES USE SEQUENCE
 SHOWN.

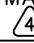
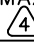

**TABLE II — CONNECTOR CODE 41
 MIL-DTL-38999, SERIES I & II**

ORDER NO.	SHELL SIZE		<i>A</i> UNIFIED THD. CLASS 2B	ϕC MAX.	<i>D</i> MAX.	<i>E</i> MAX. 	<i>F</i> MAX.	<i>G</i> MAX. 	BAND MAX. 1 PIECE ENTRY
	SER. II	SER. I							
0 8	8	9	.438-28	.703	.52	1.15	.84	1.28	0 4
1 0	10	11	.562-24	.827	.54	1.17	.97	1.34	0 6
1 2	12	13	.688-24	.953	.57	1.20	1.09	1.41	0 8
1 4	14	15	.812-20	1.077	.59	1.23	1.22	1.47	1 0
1 6	16	17	.938-20	1.203	.62	1.25	1.34	1.53	1 2
1 8	18	19	1.062-18	1.327	.63	1.26	1.41	1.59	1 3
2 0	20	21	1.188-18	1.453	.66	1.29	1.53	1.66	1 5
2 2	22	23	1.312-18	1.577	.68	1.32	1.66	1.72	1 7
2 4	24	25	1.438-18	1.703	.71	1.34	1.78	1.78	1 9

NOTES:



1. ASSEMBLY IDENT. PER MIL-STD-1285.
2. MATERIAL: COMPONENTS — ALUM. ALLOY
O'RING — SILICONE
-  "2 PIECE" CONFIG. SUPPLIED WHEN CABLE ENTRY DIA. EXCEEDS CONN. INSERT DIA..
-  DIMENSIONS INDICATED WILL BE .20" LESS WHEN ORDERED WITH MOD. CODE Z.
-  FOR MULTIPLE MOD. CODES USE SEQUENCE SHOWN.



TABLE II — CONNECTOR CODE 54

MIL-DTL-26482, SERIES 2
 MIL-DTL-5015G, 3400 SERIES
 MIL-C-81703, SERIES 3
 MIL-DTL-83723, SERIES I & III
 NAS1599

ORDER NO.	SHELL SIZE		A UNIFIED THD. CLASS 2B	øC MAX.	D MAX.	E MAX. △4	F MAX.	G MAX. △4	BAND MAX. 1 PIECE ENTRY
	△7	△6							
0 3	3	-	.562-24	.71	.55	1.15	.84	1.28	0 4
0 8	-	8,8S	.500-20	.71	.55	1.15	.84	1.28	0 4
1 0	-	10,10S,10SL	.625-24	.78	.57	1.17	.97	1.31	0 6
1 2	7	12,12S	.750-20	.90	.60	1.20	1.09	1.38	0 8
1 4	12	14,14S	.875-20	1.03	.61	1.21	1.16	1.44	0 8
1 6	19	16,16S	1.000-20	1.15	.64	1.24	1.28	1.50	1 0
1 8	27	18	1.062-18	1.23	.65	1.25	1.34	1.53	1 2
2 0	37	20	1.188-18	1.36	.68	1.28	1.47	1.59	1 4
2 2	-	22	1.312-18	1.48	.70	1.30	1.59	1.66	1 6
2 4	-	24	1.438-18	1.61	.73	1.33	1.72	1.72	1 8
2 8	-	28	1.750-18	1.99	.78	1.38	1.97	1.88	2 0
3 2	-	32	2.000-18	2.24	.83	1.43	2.22	2.00	2 4
3 6	-	36	2.250-16	2.49	.86	1.46	2.34	2.13	2 4
4 0	-	40	2.500-16	2.74	.91	1.51	2.59	2.25	2 4
4 4	-	44	2.750-16	2.99	.96	1.56	2.84	2.38	2 4
4 8	-	48	3.000-16	3.24	1.01	1.61	3.09	2.50	2 4
6 1	61	-	1.500-18	1.67	.74	1.34	1.78	1.75	1 8

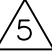
NOTES:

1. ASSEMBLY IDENT. PER MIL-STD-1285.
2. MATERIAL: COMPONENTS — ALUM. ALLOY
O'RING — N/A

△7 SIZES PER MIL-C-81703, SERIES 3.

- △3 "2 PIECE" CONFIG. SUPPLIED WHEN CABLE ENTRY DIA. EXCEEDS CONN. INSERT DIA..
- △4 DIMENSIONS INDICATED WILL BE .20" LESS WHEN ORDERED WITH MOD. CODE Z.
- △5 FOR MULTIPLE MOD. CODES USE SEQUENCE SHOWN.
- △6 SIZES PER MIL-DTL-5015 (3400 SERIES), MIL-DTL-26482 (SERIES 2), MIL-DTL-83723 (SERIES I & III), & NAS1599.